



Mission

Empowering LGBT Choruses as we change our world through song.

Vision

A world where all voices are free.

Core Values

We are **CATALYSTS**. We provide enthusiasm, resources and tools to inspire our member choruses to use the power of music to create social change.

We are **HARMONIZERS**. We are diverse people who employ the power of song with respect and understanding. We bring our communities together to experience musical excellence, collaboration, cooperation, acceptance, transparency, and opportunities for all.





Mission

Empowering LGBT Chorus as we change our world through song.

Vision

A world where all voices are free.



Core Values continued...

We are **LISTENERS**. We listen to our members, our colleagues, and each other in order to understand the issues, define our roles, and serve the common welfare of our movement.

We are **LEADERS**. We offer strategic direction to the movement we serve. We work effectively with partners around the world who seek to achieve complimentary goals. We strengthen our association by nurturing effective leadership and ensuring robust, sustainable financial resources.



FESTIVAL
GALA CHORUSES
DENVER • 2016

The logo features a stylized mountain range with three peaks in orange, blue, and green. Below the mountains, the word "FESTIVAL" is written in large, green, block letters, with a white musical staff and notes integrated into the letters. Underneath, "GALA CHORUSES" and "DENVER • 2016" are written in smaller, blue, sans-serif font.

The hills are alive!



Get Ready to Experience the Love !

GALA Festival will be one of the most exciting and supportive performing experiences you will ever have!

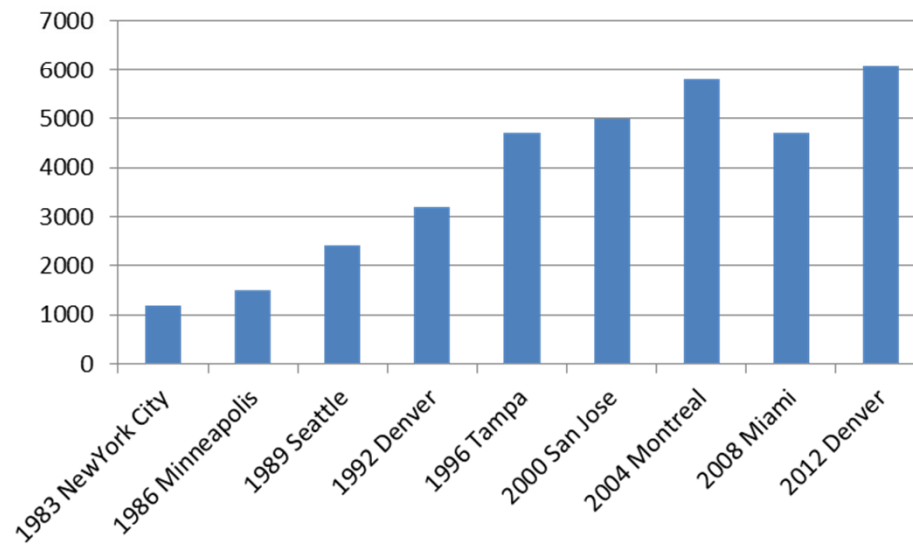

Festival 2016 will be the 10th GALA Festival

**Expecting over 6,000 singers
representing 150-160 choruses and ensembles**



What's New for Festival 2016

- Video introductions from each chorus
- Flash mob in downtown Denver
- Show Tune Showdown
- Outdoor stage in Galleria
- Mobile phone program - no hard copy program
- Chorus photos are on your own - risers available in the galleria
- Archival audio recordings only



The Denver Performing Arts Complex

One of the largest arts complexes in the world featuring 10 performance spaces connected by an 80-foot-tall glass roof.

- Ellie Caulkins Opera House
- Boettcher Concert Hall
- Temple Hoyne Buell Theatre
- Stage Theater & Seawell Ballroom



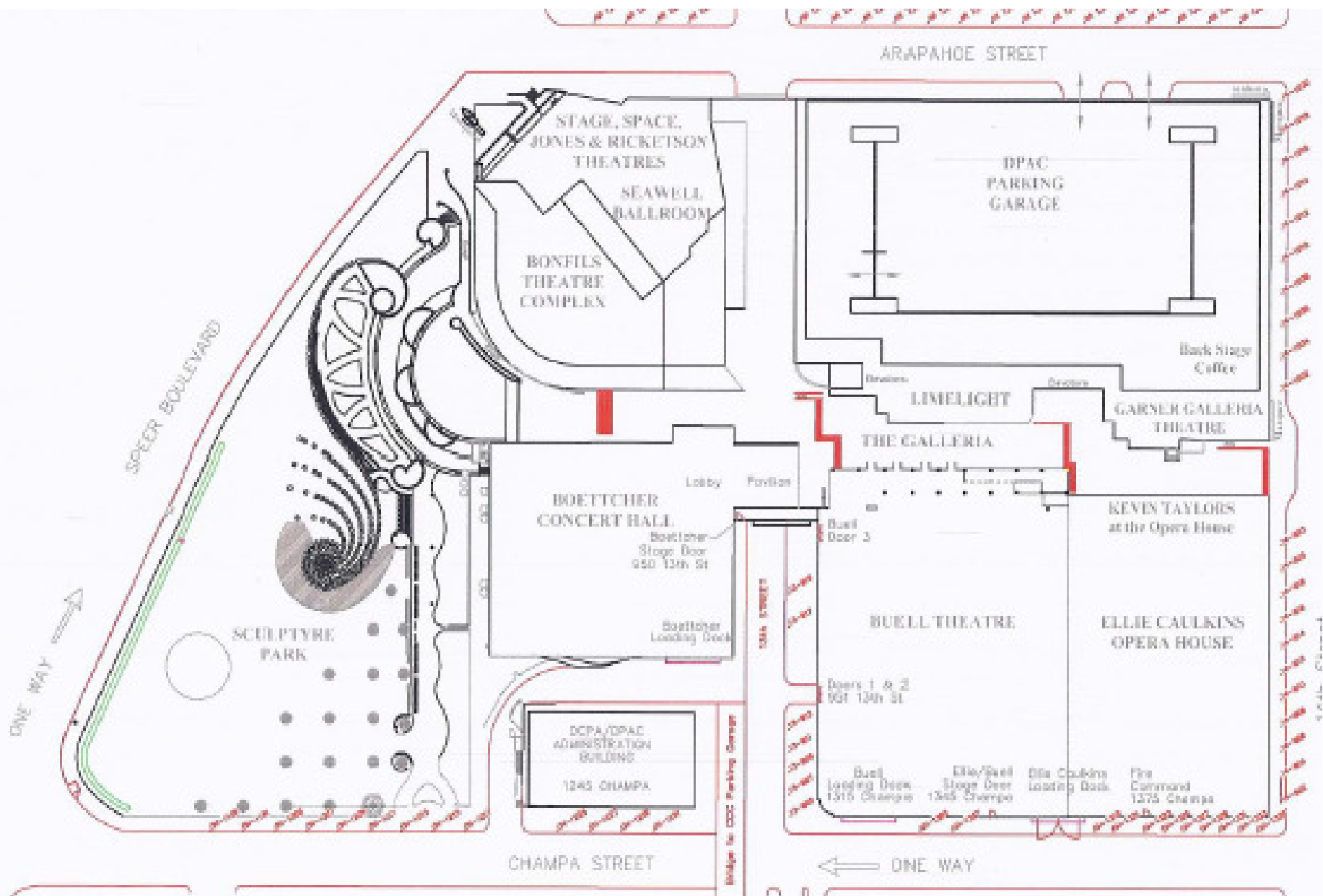



Ellie Caulkins Opera House – 2,225 seats

The Ellie Caulkins Opera House, colloquially known as “the Ellie,” seats 2,225. The Ellie, a world-class acoustical hall designed in the lyric style, encompasses four levels: the balcony, loge, mezzanine and orchestra. This magnificent space provides state-of-the-art technical support as well as acoustical excellence and clean sight lines. The Ellie is one of only three opera houses in the United States with seatback titling at every seat in the house



Boettcher Concert Hall – 2,700 Seats

Boettcher Concert Hall is a 360-degree-surround concert hall placing the audience close to the stage while surpassing traditional symphonic sound quality. 80% of the seats are within 68 feet of the stage. While the news reported a possible renovation for this hall, the Denver Performing Arts Complex reports that it construction work will not begin in Boettcher before 2017.



Buell Theater – 2,882 seats

The Buell Theatre is a 2,882 seat state-of-the-art theatre designed to provide the audience with a first rate theatrical experience featuring incredible acoustical enhancements. From hosting major national Broadway tours to stand-up comedy, the Buell can facilitate almost any show. Its stage accommodates the most lavish sets and most ambitious productions. Every seat in the house has excellent sight lines and provides a sense of closeness to the stage



**Stage Theater – 750 seats
Ensemble Showcase**



NEW for 2016!

**Seawell Ballroom –
900 seats
Late-night Ensemble Concerts**

Seawell Ballroom offers state of the art lighting and sound combined with a stunning view of the city of Denver and the Rocky Mountains



Festival 2016 Performance Schedule Example

	Sat, July 2				Sun, July 3				Mon, July 4				Seawell Ballroom	Tues, July 5				Wed, July 6			
	Boettcher	Buell	Ellie	Stage	Boettcher	Buell	Ellie	Stage	Boettcher	Buell	Ellie	Stage		Boettcher	Buell	Ellie	Stage	Boettcher	Buell	Ellie	Stage
8:00 AM																					
8:30 AM																					
9:00 AM																					
9:30 AM																					
10:00 AM						Coffee Concert				Coffee Concert					Coffee Concert				Coffee Concert		
10:30 AM																					
11:00 AM							Coffee Concert				Coffee Concert				Tech		Coffee Concert			Coffee Concert	
11:30 AM																					
12:00 PM																					
12:30 PM																					
1:00 PM						Concert Block	Concert Block	Concert Block													
1:30 PM						Concert Block	Concert Block	Concert Block													
2:00 PM								Youth Concert													
2:30 PM																					
3:00 PM																					
3:30 PM																					
4:00 PM						Concert Block	Concert Block	Concert Block													
4:30 PM																					
5:00 PM						Concert Block	Concert Block	Concert Block													
5:30 PM																					
6:00 PM																					
6:30 PM																					
7:00 PM	Opening Concert					Mixed Chorus Singin' in the Round	Naked Man Singalong			Celebrating Women	Exploring Spirituality										
8:00 PM			Ensemble Concerts																		
8:30 PM																					
9:00 PM	Opening Concert			Late Night Ensemble																	
9:30 PM							African American Whatever	Late Night Ensemble													
10:00 PM																					
10:30 PM																					
11:00 PM													Late Night Ensemble								Late Night Ensemble
																					Closing Ceremonies & Party!

The Festival schedule above is an *example* from Festival 2012



July 2 Festival Opening Events

- **Opening concerts**
- **Ensemble Festival** in the Seawell Ballroom & Stage Theater
- **Colorado chorus' welcome** events in the Galleria
- **Food and drink vendors** in the Galleria and Sculpture Garden
- **Flash Mob** event





GALA Flash Mob - Denver Pavilions
500 singers



Concert Block Overview

- 15 minute tech rehearsal; practice entrance and exit and a sound check
- 30 minute set: includes entrance/exit time and all movement/transitions
- Movement of piano or instrumentalist will come out of your set time
- Stage set-up: grand piano, music stand and risers: 4 ft deep, 5 risers high (4 risers in Boettcher plus optional use of the parquet).



Programming Tips

- Plan for about 23 minutes of music as a chorus, approximately 12 minutes for an ensemble
- Plan for applause !
- Choose programming that presents a distinctive identity for your chorus; something mission-related
- You want your chorus to shine !



More on Programming

- Select repertoire that works in the hall where you are performing
- Keep instrumentation simple, better yet, sing a cappella or with piano
- Keep the audience in mind, they are being deluged with great choral music, keep your repertoire varied
- Consider collaborating with another chorus for a combined song or two

Chorus Video Introductions

- 1 minute video introduction of your chorus
- Will be played before your 30 minute concert set
- Personalize to showcase your chorus





Collaborations and Shared Concert Sets

Partner with a chorus in your community

...from another province or state

...or, from across the world!





Morning Coffee Concerts

- Limited number of 50 minute performance sets
- Performed in primary concert halls
- Can accommodate more complicated staging or instrumentation
- Chorus is responsible for backstage labor, sound, lighting costs incurred

If selected for a Coffee Concert this performance counts as your chorus' Festival performance.

Coffee Concert Timeline

Jan 31, 2015	Coffee Concert applications due
Feb/Mar 2015	Committee reviews Coffee Concert applications
May 2015	Coffee concert participants selected and notified

Blockbuster Concerts

- Opening GALA Collage Concert – with Matt Alber and Holly Near
- Mosaico – honoring GALA communities of color
- Classical Masterworks Sing-along with Colorado Symphony
- Gender Queer Celebration
- Holiday Hoopla!
- I Am Harvey Milk
- Show Tune Showdown!





More Evening Blockbusters

- Nothing Like a Dame – celebrating GALA Women
- Naked Man 20th Anniversary
- Mixed Doubles – SATB chorus’ collaborative concert
- Youth Invasion: From Gay to Z
- Closing Concert and Festival Show Stoppers





Blockbuster Timeline

March 2015	Chorus & Ensemble Festival Registration opens
July 2015	Blockbuster application due with chorus/ensemble registration
July-August 2015	Blockbuster planners review applications
September 2015	Blockbuster choruses selected and notified



Additional Performance Options

- **Flash mob** performance in downtown Denver
- **Outdoor stage** and **Photo Risers** in Galleria
- Core-chorus for the **Classical Masterworks** Sing-Along
- Ensembles in the **Show Tune Showdown**
- Submit and perform a song in a **Blockbuster concert**
- **Opening Concert**
- **Nothin Like a Dame** (SSAA)
- **Mixed Doubles** (SATB)
- **Naked Man 20th Anniversary** (TTBB)





Festival Workshops

A variety of workshops will be held each morning for registered delegates.

- **Singer workshops:** vocal-focused training, musical issues
- **Artistic Directors:** programming, conducting
- Workshops for **non-singing board members**
- Workshops for **chorus volunteers** and **administrative staff**

Start now to **encourage your non-singing volunteers** to join your chorus for the Festival experience!



GALA Youth Choruses

- **Youth Chorus performances**
- **Shared housing**
- **Workshops and guest presenters**
- **Youth Invasion Blockbuster Concert**
- **Social activities**
- **Youth dance** with queer youth from Denver



Highlights for Women at Festival 2016

- Women's Chorus **performance evening in Boulder, CO**
- Roma **Commissioning Project** Performance
- **Celebrating Women Concert**
- **Women's party** in the Stage Theatre lobby
- Festival women **late-night dance**
- Morning **workshops** feature workshops for women and women's voices

Festival Village Layout

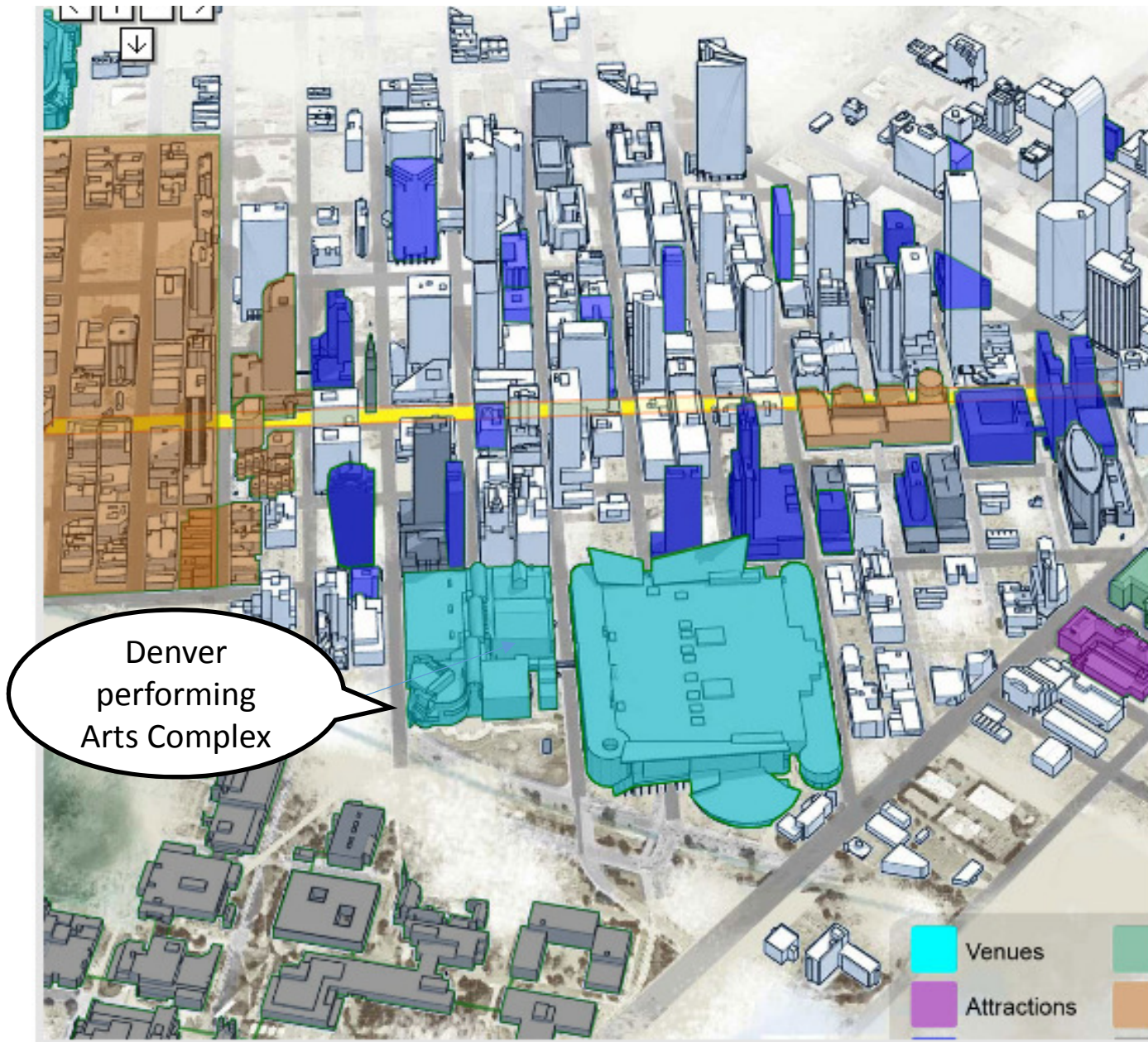

All of the Festival hotels are within six blocks of the Denver Performing Arts Complex.

The yellow line is the the 16th Street Mall, a mile long pedestrian promenade lined with shops and outdoor cafes.

Free shuttle buses leave either end as often as every 90 seconds and stop on every corner.

The dark blue structures are hotels.

Denver Hotels contracted by GALA

Prices shown are for single/double occupancy

Triple or quad occupancy available for additional charge



Hotel	Rate	Blocks to DPAC
1 Comfort Inn Downtown	\$109.00	8 Blocks
2 Courtyard by Marriott Downtown	\$149.00	2 Blocks
3 The Curtis, a DoubleTree Hotel by Hilton	\$159.00	1 Block
4 Embassy Suites Denver Downtown at the Convention Center	\$199.00	1 Block
5 Four Seasons Hotel Denver	\$209.00	1 Block
6 Grand Hyatt Denver	\$164.00	6 Blocks
7 Hampton Inn & Suites Denver/Downtown – Convention Center	\$179.00	3 Blocks
8 Hilton Garden Inn Downtown Denver	\$179.00	3 Blocks
9 Homewood Suites Denver/Downtown – Convention Center	\$197.00	3 Blocks
10 Hyatt Regency at Colorado Convention Center	\$169.00	1 Block
11 Magnolia Hotel Denver	\$149.00	3 Blocks
12 Renaissance Denver Downtown Hotel (Opening January 2014)	\$209.00	3 Blocks

Delegate Registration	
Early	225
Regular	265
Late	299
Youth/Disabled	150
Senior Early	165
Senior Regular	175
Senior Late	185



Delegate registration – web registration only

Early May 2015 – Nov. 2015
 Regular Nov. 2015 – March 2016
 Late After March 2016

Delegate fees include opening and closing concert, all concert blocks, Coffee Concerts, Blockbuster concerts and workshops. Performers must be registered delegates

Individual concert tickets for partners, etc. will be ~\$25 per concert, or they may register as a delegate for access to all events

Youth: under 21. Senior: 65 or over. Disable rate covers anyone on Social Security disability

Delegate Expense workbook

Available online at:

<http://galachoruses.org/events/gala-festival/fundraising>



Delegates					
Registration	\$ 225.00	Early	\$225		
		Regular	\$265		
		Late	\$299		
Flight & Travel	\$ 450.00	<i>(example rate - plus \$20-60 for local travel)</i>			
Hotel	\$ 254.25	<i>(example, quad room for five nights)</i>			
		Room	Tax		
		180	1.13	Cost of \$180 room per night + 13% taxes	
		Nights	Room Cost	Each for 2	Each for 3
		1	\$ 203.40	\$ 101.70	\$ 67.80
		2	\$ 406.80	\$ 203.40	\$ 135.60
		3	\$ 610.20	\$ 305.10	\$ 203.40
		4	\$ 813.60	\$ 406.80	\$ 271.20
		5	\$ 1,017.00	\$ 508.50	\$ 339.00
		6	\$ 1,220.40	\$ 610.20	\$ 406.80
		7	\$ 1,423.80	\$ 711.90	\$ 474.60
Food	\$ 200.00	Cheap	\$25/day		
		Middle	\$40/day		
		Expensive	\$80/day		
Delegate Costs	\$ 1,129.25				



Chorus Member Scholarships

In order to make Festival as accessible as possible, GALA Choruses is offering one waived registration for every 20 delegates registered from your chorus.

We welcome any choruses that have raised sufficient funds for their singers to attend Festival to “donate” their free registrations to a chorus with fewer resources.





Festival Communication

Webinars: Introduction to Festival, programming for ADs, housing info

GALA Website: for updated Festival info and registration

Festival Budget Spreadsheet: on website

Fundraising Tips and Tools for Festival: on website

E-blasts



Countdown to Festival 2016

March 2015	Chorus & Ensemble Registration Opens
May 2015	Early delegate registration opens – web registration only
July 1, 2015	Chorus Registration Deadline Blockbuster applications due (with chorus registration)
Sept 2015	Blockbuster participants selected
November 2015	Chorus performance schedule announced
January 2016	Festival housing registration opens
April 2016	Music Program and rehearsal space requests due Video Introductions , song & tech information due
May 2016	Banner and consigned merchandise orders due
July 2-6, 2016	GALA Festival 2016